

CENTRIFUGAL FAN VBM3

SINGLE INLET CENTRIFUGAL FAN

GENERAL CHARACTERISTICS:



MOTOR TYPE: Shaded pole, IP44

NOMINAL SUPPLY: 240V 1Ph 50Hz
110V 1Ph 60Hz

OPTIONS: Inlet & discharge guards

MATERIALS: Fancase: Cast aluminium LM6
Impellers: Aluminium 1200 H14

FINISHES: Unpainted/Stove enamel (black) as std

MOUNTING OPTIONS: Inlet & discharge tappings

NOISE LEVELS: 72.5dB(A) Free Air, 1M

WEIGHTS: 1.8Kgs / 3.9Lbs

MOTOR VARIATIONS: CE, CSA, UL available

PERFORMANCE CURVES:

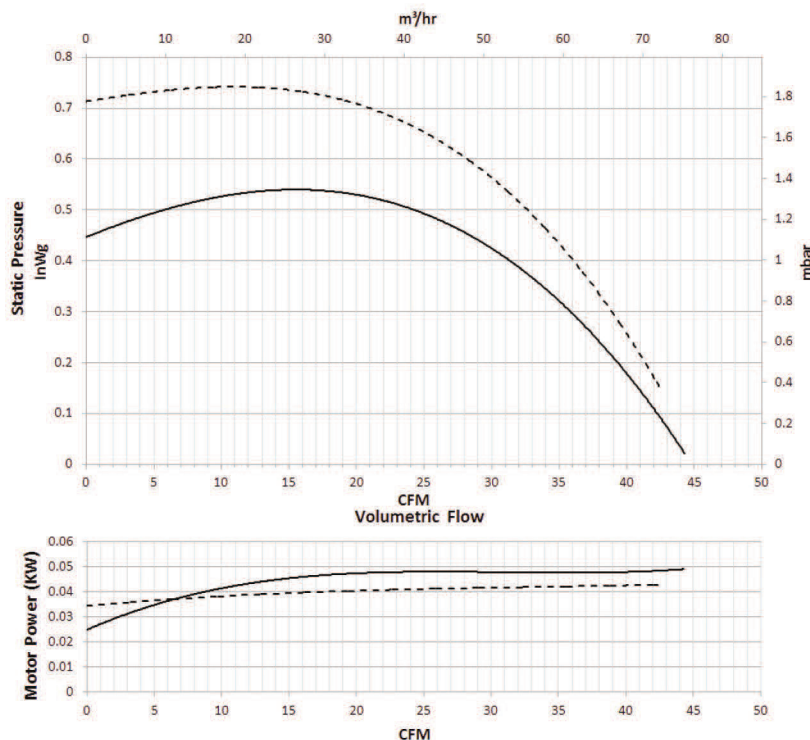

CENTRIFUGAL FAN VBM3

SINGLE INLET CENTRIFUGAL FAN

OUTLINE DIMENSIONS:

[note: motor shown is for 50Hz performance. Motor dimensions for 60Hz operation may vary]

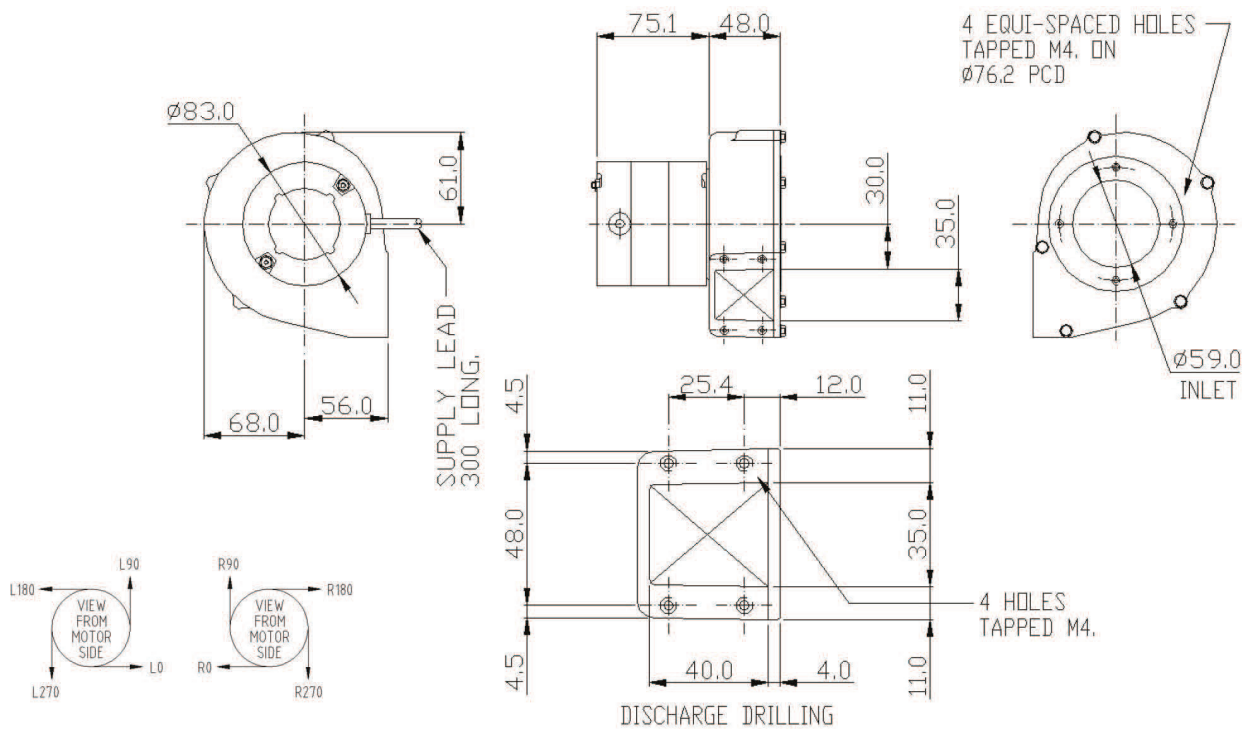

PLEASE NOTE:

1. all drawings measurements are in millimeters (mm)
2. above technical specifications are subject to change
3. Images used may not be representative of the fan supplied